

C.I.P.

7,62 x 39

Country of Origin: SU

TAB.	I
Date	89-01-04
Revision	02-05-15

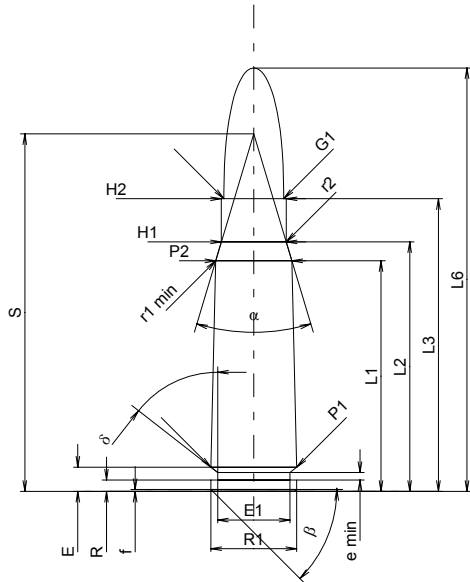

CARTRIDGE MAXI

Lengths

L1 ¹⁾	=	30.50	-0.20
L2 ¹⁾	=	33.00	-0.20
L3 ¹⁾	=	38.70	
L4	=		
L5	=		
L6	=	56.00	

Case Head

R	=	1.50	
R1	=	11.35	
R3	=		
E	=	3.20	
E1	=	9.56	
e min	=	1.00	
delta	=	51°58'12"	
f	=	0.25	
beta	=	45°	

Powder Chamber

P1	=	11.35	
P2 ¹⁾ *	=	10.07	-0.20

Junction Cone

alpha	=	32°46'	
S	=	47.28	
r1 min	=	4.00	
r2	=	3.00	

Collar

H1*	=	8.60	
H2 ¹⁾	=	8.60	

Projectile

G1 ¹⁾	=	7.92	
G2	=		
F	=		
L3+G ¹⁾	=	46.70	

Pressures (Energies)

Method Transducer

Pmax	=	3550 bar
PK	=	4083 bar
PE	=	4440 bar
M	=	25.00
EE	=	2510 Joule

Miscellaneous Dimensions

Fe ¹⁾	=	0.15
delta L	=	

CHAMBER MINI

Lengths

L1*	=	30.25
L2*	=	32.55
L3 ¹⁾	=	41.00

Breech

R	=	1.50
R1	=	11.37
R2	=	
R3	=	
r	=	

Powder Chamber

E	=	3.50
P1 ¹⁾	=	11.36
P2*	=	10.12

Junction Cone

alpha ¹⁾	=	33°23'56"
S	=	47.12
r1 max	=	0.50
r2	=	3.00

Collar

H1*	=	8.74
H2 ¹⁾	=	8.60

Commencement of Rifling

G1 ¹⁾ *	=	8.60
G ¹⁾ *	=	8.00
alpha1	=	
h	=	
s	=	
i ¹⁾	=	3°30'18"
w	=	

Barrel

F ¹⁾ *	=	7.62
Z ¹⁾	=	7.92

Grooves

b	=	3.81
N	=	4
u	=	240.00
Q	=	47.99 mm ²

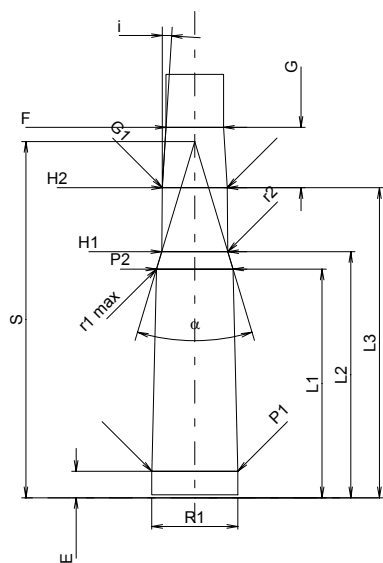

Scale 1:1

Dimensions in << mm >>
Dimensions and Tolerances for Proof Barrels
see Appendix CR 1.

Notes: 1) Check for safety reasons
* Basic dimensions